

DRINKS | Chestcooler

HORIZONTAL COOLERS

BTL 2000



DETAILS

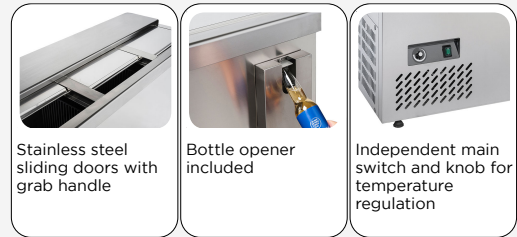

GENERAL FEATURES

- Horizontal cooler with N.4 sliding door
- Stainless Steel exterior and interior
- Static Cooling
- Manual Defrost
- Rear and lateral side airflow panel holes
- Foaming Agent Cyclopentane (45mm per side)
- Mechanical thermostat
- Easy removable top
- Stainless steel sliding doors with grab handle
- Bottle opener included
- Independent main switch
- N.4 Adjustable feet
- Energy efficiency class: -

TECHNICAL SPECIFICATIONS

Capacity	560 L
Temperature	+0° - +8°C
Consumption	1.8 kWh/24h
Rated Power	200 W
Noise level	53 dB(A)
Net Weight	86.5 Kg
Gross Weight	112 Kg
External Dimensions (WxDxH mm)	2000x575x865
Internal Dimensions (WxDxH mm)	1895x470x765
Packaging dimensions (WxDxH mm)	2040x610x1015
Loading quantities 20'/40'/40"HQ	18/38/38

PRODUCT DIMENSIONS

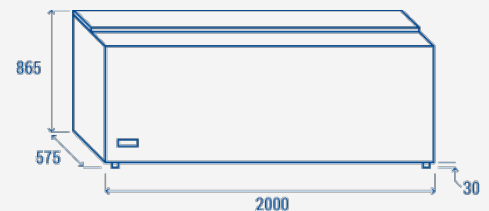

CERTIFICATION



RIGHTWAY ASIA
We make the world a cooler place