

INOX | Upright Cabinets

REFRIGERATED CABINETS ▶ VENTILATED ▶ CHILLER

QR 4



DETAILS

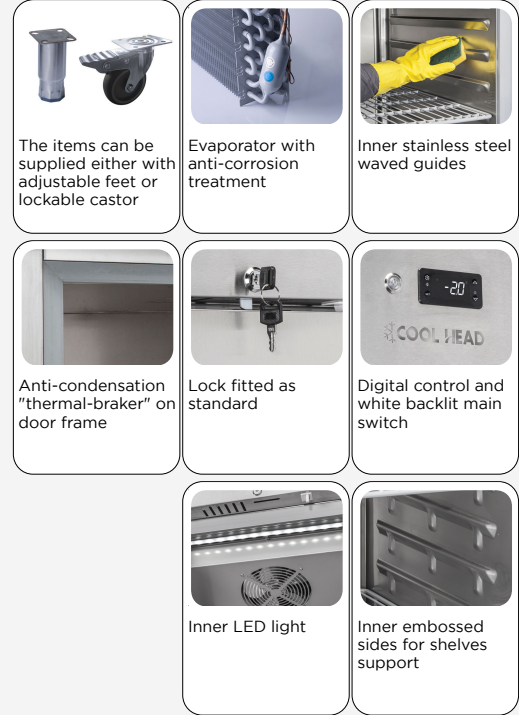

GENERAL FEATURES

- 400 Lt. Refrigerated upright
- Stainless Steel exterior and interior
- Plastic thermal-braker anti-condensation as chamber body frame
- Ventilated Cooling
- Evaporator with anti-corrosion treatment
- Hot gas defrost system
- Foaming Agent Cyclopentane (70mm)
- Curved edge for easy cleaning
- Digital Thermostat
- White backlit main switch
- LED light and lock fitted as standard
- Removable Gasket
- Door: Self closing and reversible door fitted as standard
- Foamed door handle
- Adjustable shelves: 3 Pcs + 1 BOTTOM Shelf
- N.4 Adjustable feet - S/S feet or castor with brake (Option)
- Energy efficiency class: D

TECHNICAL SPECIFICATIONS

Capacity	450 L
Temperature	-2° - +8°C
Consumption	1.759 kWh/24h
Rated Power	180 W
Noise level	50 dB(A)
Net Weight	93.00 Kg
Gross Weight	114.00 Kg
External Dimensions (WxDxH mm)	680x730x1975
Internal Dimensions (WxDxH mm)	534x580x1465
Packaging dimensions (WxDxH mm)	700x745x2105
Loading quantities 20'/40'/40'HQ	24/48/48

CERTIFICATION



PRODUCT DIMENSIONS

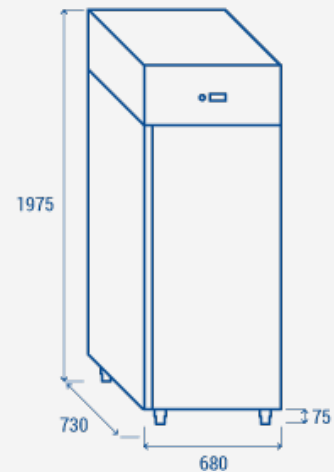

RIGHTWAY ASIA
We make the world a cooler place