

ABS | Upright Cabinets

REFRIGERATED UPRIGHT ► INOX



GENERAL FEATURES

400 Lt. Refrigerated upright	•
S/S external cabinet, thermoformed internally	•
Roll-bond evaporator system with fan assisted cooling	•
Automatic compressor cycle defrost	•
Foaming Agent Cyclopentane (70mm per side)	•
Digital Thermostat	•
Independent back-lit main switch (White color)	•
Removable Gasket and handle along door profile	•
Door: Self closing and reversible door fitted as standard	•
Doors lock fitted as standard	•
Adjustable shelves: 4 Pcs + 1 BOTTOM Shelf	•
N.2 Adjustable feet + N.2 Rollers at the back	•
Energy efficiency class: C	•

TECHNICAL SPECIFICATIONS

Capacity	400 L
Temperature	+0°C ~ +10°C
Consumption	1.359 kWh/24h
Rated Power	155 W
Noise level	54 dB(A)
Net Weight	65 Kg
Gross Weight	79 Kg
External Dimensions (WxDxH mm)	600x625x1863
Internal Dimensions (WxDxH mm)	458x465x1603
Packaging dimensions (WxDxH mm)	640x705x2000
Loading quantities 20'/40'/40'HQ	27/54/54

CERTIFICATION

CE RoHS

URX 4



DETAILS

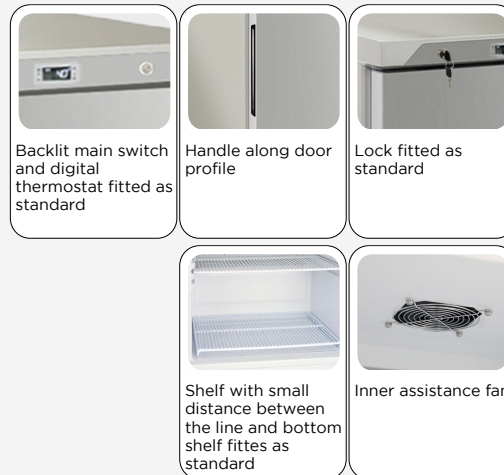

PRODUCT DIMENSIONS

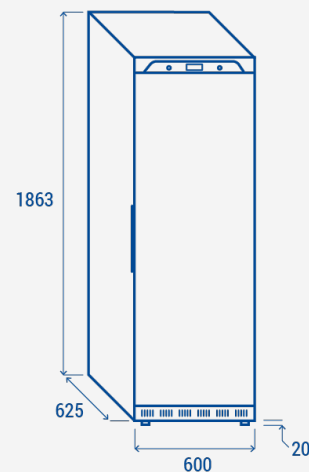

RIGHTWAY ASIA
We make the world a cooler place